

VSE

Extruder

Features

- ▷ Accurate temperature control
- ▷ Tied in with the P-touch screen
- ▷ Melting capacities of up to 120 kg/h (264 LBS/h) depending on glue type
- ▷ Fast change over between glue types with removable hopper
- ▷ Can be retrofitted to existing applications
- ▷ Can be connected with a heated hose
- ▷ Continuous melting process with out production stop to refill with new glue



Precise Melting for Fast Production

This melting unit can process all types of commercially available hot melt glues in granular form. The function of this extruder assures melting uniformly. The unit is equipped with heating elements that are tied in with the P-touch screen allowing for automatic glue level control and start and stop time of the heating elements. The heating elements are only used to bring the unit up to working temperature in the morning and to maintain the working temperature when not in use. The melting process is done by means of an auger that feeds the granular glue through a pipe and compressing it at the same time. This will result in increasing friction and temperature to the point of which the granular glue melts. This assures that the melting temperature is constant and automatically adjusted to each glue type.

The melting capacity depends on the glue type being used.

When using polyolefine glue the melting capacity can be reduced by as much as 50% due to the material properties.

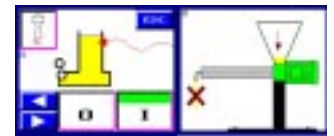

Safe and simple operation

The VSE units in combination with an automatic glue level control are part of the P-touch screen control.

Type	VSE 30	VSE 60	VSE 120
Melting capacity	up to 30 kg/h up to 66 LBS/h	up to 60 kg/h up to 132 LBS/h	up to 120 kg/h up to 264 LBS/h
Power consumption	5.6 kW	13.4 kW	16.9 kW